



Trenching & Leveling Block Systems and Accessories



ROAD REHABILITATION | DRILLING | TRENCHING

SOLID

Innovation Quality Service

The foundation for a successful trenching operation is built on rock-steady reliability and progress. Kennametal, the world's leading tooling and services provider, proudly introduces SOLID, our solution-focused platform that yields new levels of performance and productivity. SOLID-engineered tools deliver in the most challenging conditions.

**For unmatched quality, value, innovation, and application expertise,
make Kennametal your SOLID choice!**





Value Application Expertise

Proven Reliability – Unparalleled Productivity.

Trenching Block Series

For 11 mm (.44") and 14 mm (.55") Tools

CMB4 Block 1012281

Accepts CM42 cutting tools. All blocks are easily welded with a 7018 or 8018 low-hydrogen rod or equivalent wire.

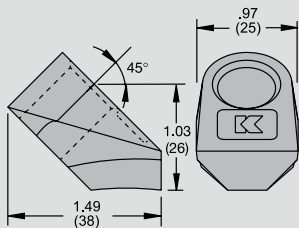

CMB6 Block 1321008

Accepts CM63 cutting tools. All blocks are easily welded with a 7018 or 8018 low-hydrogen rod or equivalent wire.

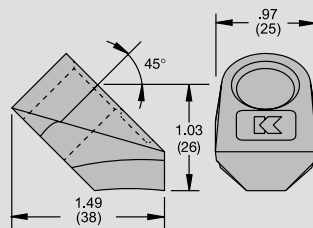

CMB6L Block 1898353

For use with CM61 and CM65 cutting tools. Heavy-duty design and longer bore to accept LR-style tools.

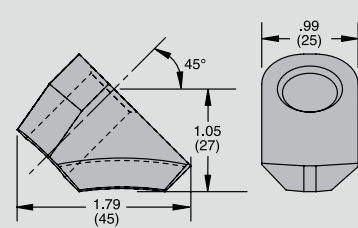

For 19 mm (.74") Tools

C20 Block 1012273

Slim-block profile.

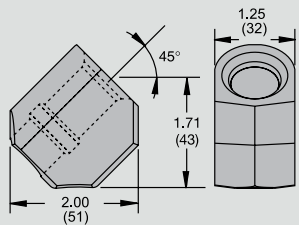

C20HD Block 1012276

Heavy-duty design.

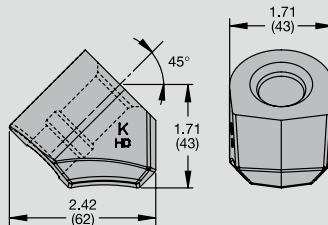

C3RB Block 1886760

For heavy-duty applications. Taller block enables clearance for externally retained tools.

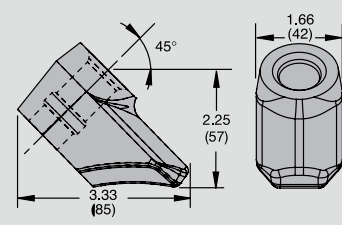

For 20 mm (.76") Tools

C10 Block 1012278

For light-duty applications. Slim profile design.

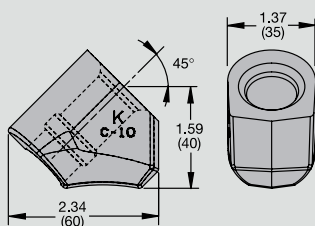

C10H Block 1012280

For medium-duty applications.

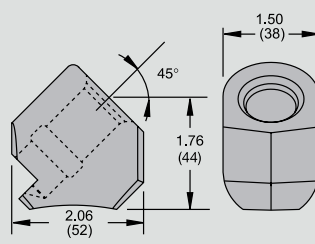

C10HD Block 1012289

For extra heavy-duty applications.

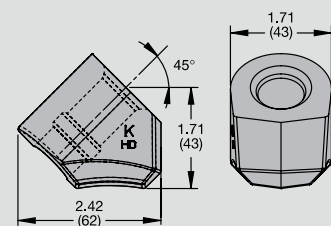

For 22 mm (.87") Tools

C87B Block 1012275

Has a machined step to accept AR150 87 tools. All blocks are easily welded with a 7018 or 8018 low-hydrogen rod or equivalent.

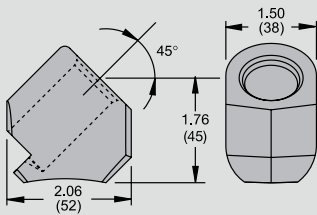

C87E Block 1012365

For heavy-duty applications. Shorter bore length accepts SL06 cutting tool.

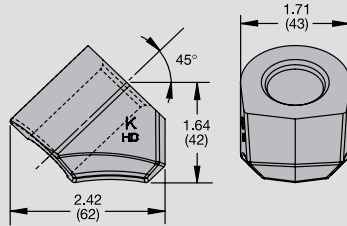

C87G Block 1012234

Medium-duty design with internal groove to accept SL09 tools. Also accepts AR150 87 tools.

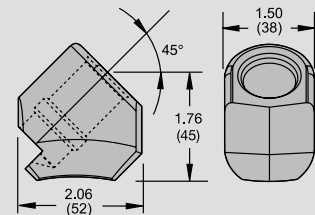

C87HDS Block 1012290

For heavy-duty applications.

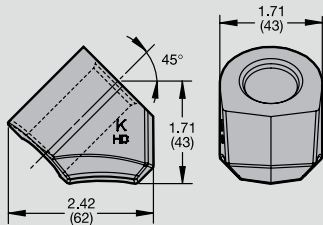

C87HDG Block 1972929

For heavy-duty applications. Features internal groove to accept SL09 cutting tools.

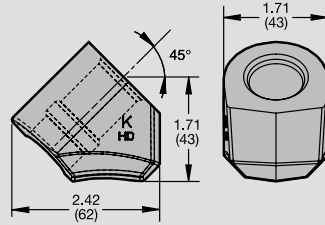

SLB01 Block 1858587

For heavy-duty applications. Features extra clearance for SL06 and SL07 cutting tools.

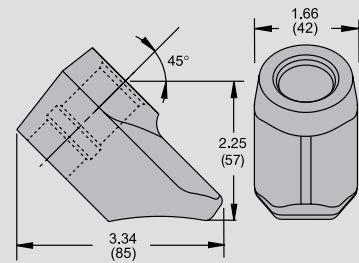

For 25 mm (.1") Tools

C30 Block 1012279

All blocks are easily welded with a 7018 or 8018 low-hydrogen rod or equivalent.

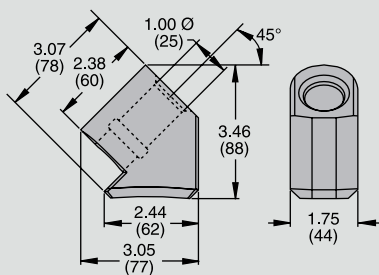

C30H/U40H Block 1011585

Heavy-duty design.

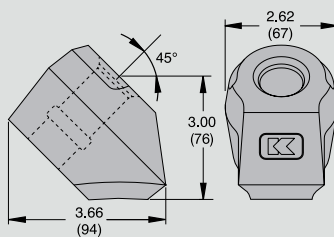

TH3-100 Block 2956994

Extra heavy-duty design.

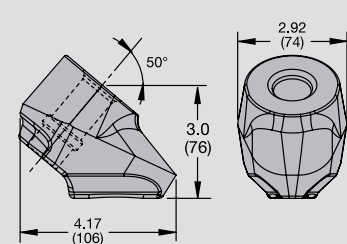

For 30 mm (1.18") and 38 mm (1.5") Step-Shank Tools

C4/U43H* Block
1011578

For medium-duty applications.

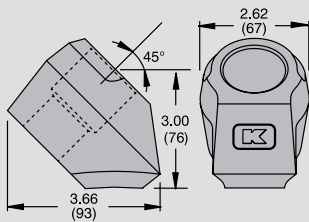

TH3* Block
2433922

Heavy-duty barrel for maximum strength and rigidity.

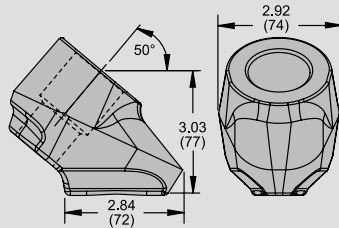

TH3S* Block
2603270

Heavy-duty barrel and short base for bolt clearance on chains.

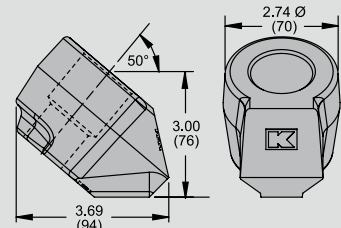

MTB1 Block
3392835

Heavy-duty barrel for maximum rigidity and durability. Raised cannon feature on face for enhanced tool rotation.

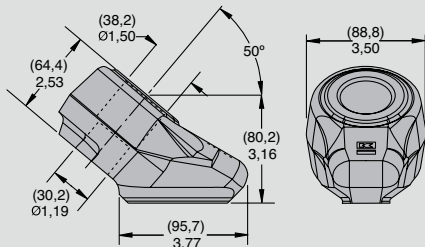

MTB2S Block
3504241

Heavy-duty barrel for maximum rigidity and durability. Raised cannon feature on face for enhanced tool rotation. Short body.

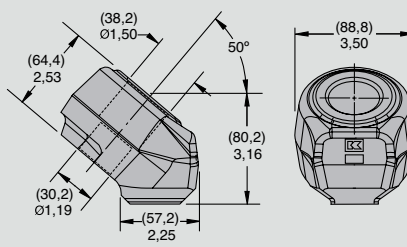

U43XHD Block**
1547387

For heavy-duty applications. For terrain levelers and large-track trenchers.

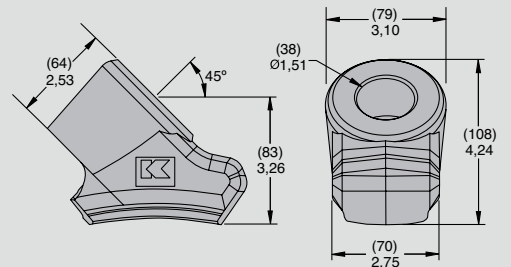

U43XHD-50 Block**
2988596

For heavy-duty applications. For terrain levelers and large-track trenchers. Has a 50° attack angle.

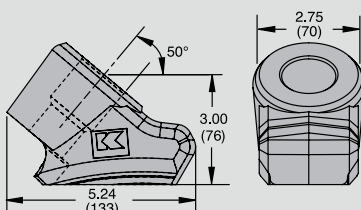

K30STS Block
3737342

Heavy-duty barrel and strap for exceptional strength and reliability. Locator pins enable accurate alignments in field. Maximum weld area.

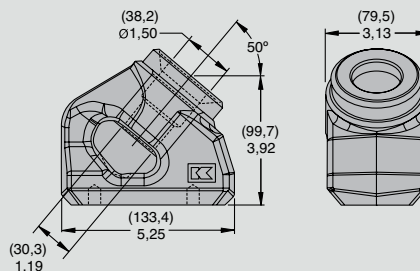

*Can be used with all step-shank tools.

**Can only be used with TS Series tools. Not compatible with TSC Series.

Accessories

Installation and Removal Tools

TR1 Puller 1927011

For use on any T-series tool with TR1 retainer.

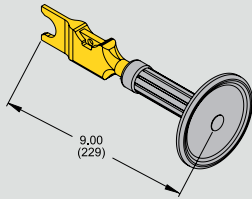

TR3 Puller 1930105

For use on TSC-series step shank tools with TR3 retainer.

C21R Puller 1012348

C31R Puller 1012347

C15R Puller 1885470

Lock ring removal tools.

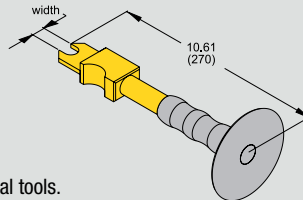

Description	Shank Series	Width
C21R	.74" and .76"	.48" (12)
C31R	.86" and 1"	.66" (17)
C15R	TS	.83 (21)

KHP 2 Hammer Punch 1012247

For removing tools from rear of block bore. Can be used with most block styles.

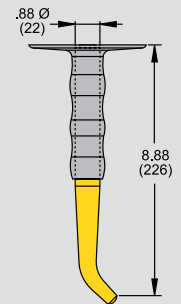

U70 Pad Coated Puller 3043394

For removal of 1" shank tools with collars.



K150 Pad Coated Puller 3043352

For removal of step shank tools with collars.

Hammer-Type Pullers for Removal of Cutting Tools

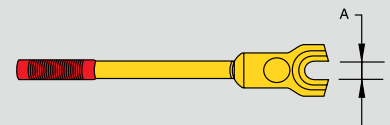

Packaging Information			
Series	Description	"A" Dimension	Handle
C30	C30 HP Puller (1011982)	1.15 (29)	Blue
C20	C20 HP Puller (1011984)	.84 (21)	Black
RS, RL, SM, SL	C123 Puller (1012016)	.91 (23)	Green
RP	RP Puller (1761401)	1.02 (26)	Red

Snap Rings

KR112 1011979

For step shank tools.



TR1 1900186

For use on any T-series tools.



CM4 1012223

For CM42 tools.

SHR87 1011938

For SL06 tools.

Lock Rings

SLR 1817888

For SL07 tools.



C31R 1012065

For externally retained 1" shank tools. (C30 and T-series)

C15R 1803295

For TSC-series tools.

C21R 1011961

For C21RHD, C21RFHD, and C21RF tools.



C3R 1012120

For C3R tools.

TR3 4073124

For use on any TSC-series step shank tools.



Pliers

KRP-1/C4 Pliers 1012010

For removal of KR112 snap ring.



KRP-4 Pliers 1012047

For removal of KR112 snap ring.



Replaceable Tips 1012047



Retainers

CM6L Retainer 1595671

Hardened lock ring for CM61, CM62, and CM63 cutting tools.



CM6H Hairpin Retainer 1777806

For CM61 and CM63 tools.



Kennametal

The proven global leader in the design, manufacture, implementation, and sale of premium-quality tooling systems for underground and surface mining, road rehabilitation, aggregates production, and waste recycling!

United States / Canada / Mexico

Phone: 800.458.3608

Fax: 800.521.3319

mcs-na.service@kennametal.com

Germany / European Served Area

Phone: (49) 6172 737 498

Fax: (49) 6172 737 42 453

mcs-ag.service@kennametal.com

Poland / Slovakia / Baltics

Phone: (48) 32 47 89 100

Fax: (48) 32 47 89 112

Brazil / Latin America

Phone: (55) 19 3936 9200

Fax: (55) 19 3936 9201

Argentina

Phone: (54) 011 4719 0700

Fax: (54) 011 4719 6116

Chile

Phone: (56) 2 2641177

Fax: (001) 888 442 4964

China

Phone: (86) 400 6501 388

Fax: (86) 10 8561 5263

Japan

Phone: (81) 3 3820 2855

Fax: (81) 3 3820 2800

Korea

Phone: (82) 2 2109 6967

Fax: (82) 2 2109 6981

Thailand / Singapore / Vietnam / Philippines

Phone: (66) 2642 3455

Phone: (66) 2246 8025 – 32

Fax: (66) 2641 2736 – 8

Malaysia / Indonesia

Phone: (6) 03 5569 9080

Fax: (6) 03 5569 0080

India

Phone: (91) 80 2839 4321

Phone: (91) 80 2219 8444

Fax: (91) 80 2839 1300

bangalore.information@kennametal.com

Australia / New Zealand

Phone: (61) 7 3801 5844

Fax: (61) 7 3801 5826

sydney.service@kennametal.com

South Africa / Sub Saharan Area

Phone: (27) 11397 3540

Fax: (27) 11397 3222



Kennametal Inc.
1600 Technology Way
Latrobe, PA 15650
USA

WWW.KENNAMETAL.COM